

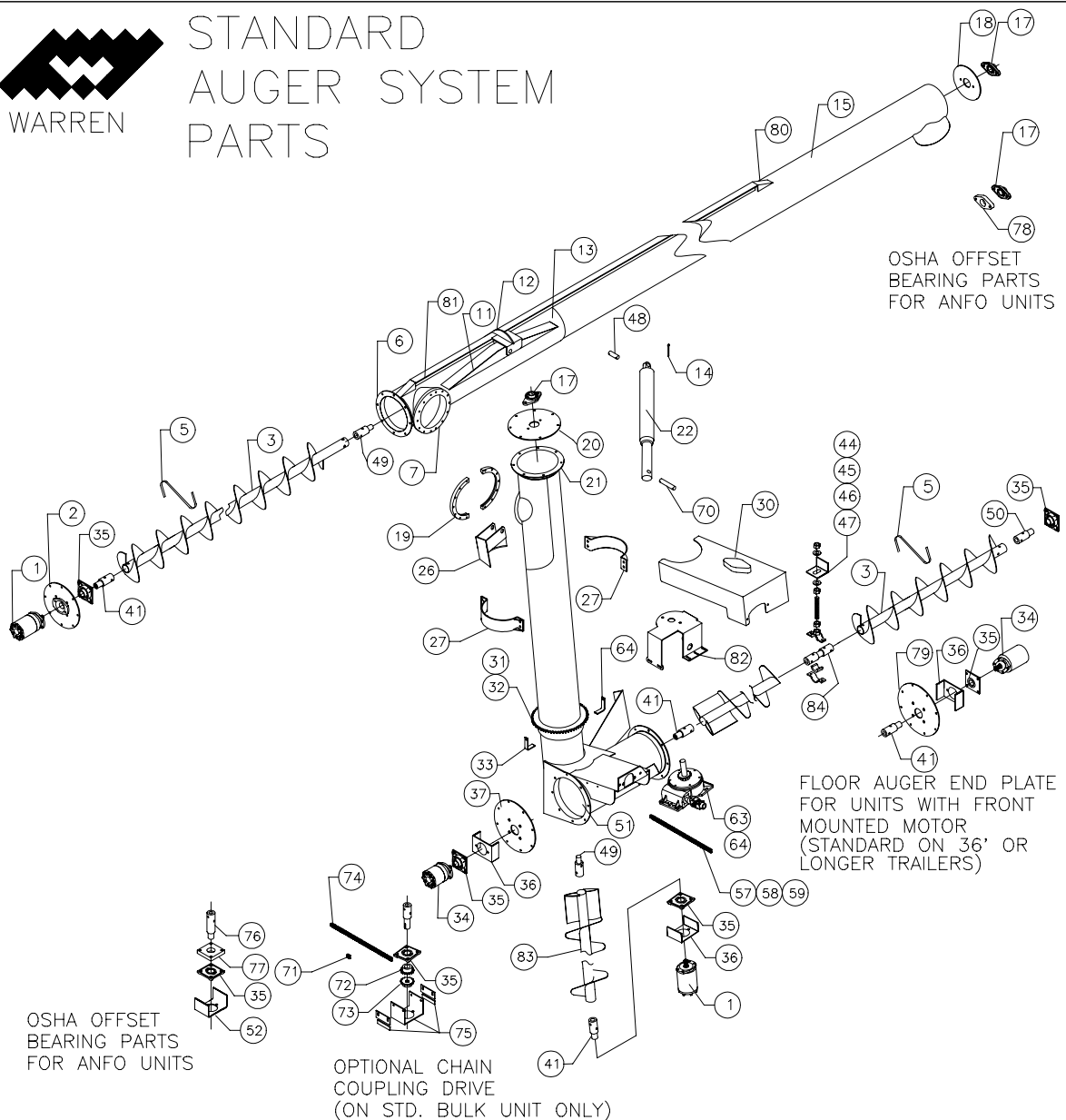

STANDARD AUGER SYSTEM PARTS



OSHA OFFSET
BEARING PARTS
FOR ANFO UNITS

FLOOR AUGER END PLATE
FOR UNITS WITH FRONT
MOUNTED MOTOR
(STANDARD ON 36" OR
LONGER TRAILERS)

OSHA OFFSET
BEARING PARTS
FOR ANFO UNITS

OPTIONAL CHAIN
COUPLING DRIVE
(ON STD. BULK UNIT ONLY)

ITEM	PART#	DESCRIPTION
1	400-0031	DISCHARGE/VERTICAL HYD. MOTOR
2	700-00223	DISCHARGE MOTOR MOUNTING PLATE
3	700-00026	9" AUGER RAW MATERIAL
4	700-00101	POP RIVET
5	700-00102	NYLON FLIGHTING WRAP
6	700-00027	BOLTING ANGLE RING
7	700-00030	MACHINED CROSSOVER RING
8	700-00029	DISCHARGE BONNET
9	700-00021	RAM BRACKET STIFFENER
10	700-00022	RAM BRACKET STIFFENER
11	700-00028	RAM BRACKET STIFFENER END CAP
12	700-00020	RAM BRACKET
13	700-00031	RAM BRACKET PAD
14	700-00100	COITTER PIN FOR HYD. CYLINDER
15	700-00029	DISCHARGE TUBE RAW MAT.
16	700-00018	DISCHARGE TUBE DOWN SPOUT
17	700-80003	2-HOLE FLANGE BEARING
18	700-00023	STEEL DISCHARGE END PLATE
19	700-00086	SPLIT-RING ASSEMBLY
20	700-00083	VERTICAL TUBE TOP PLATE
21	700-00090	BOLTING ANGLE RING
22	400-00002	HYDRAULIC CYLINDER
23	700-00093	MACHINED CROSSOVER RING
24	700-00094	VERTICAL TUBE BONNET
25	700-00095	RAM BRACKET PAD
26	700-00084	RAM BRACKET
27	700-00089	PIVOT BAND ASSEMBLY
28	700-00085	WEAR BAND
29	700-00081	VERTICAL TUBE RAW MATERIAL
30	700-00209	TURN DEVICE CHAIN GUARD
31	700-00123	VERTICAL TUBE SPROCKET(SINGLE#60)
32	700-00128	VERTICAL TUBE SPROCKET(SINGLE#80)
33	700-00267	REAR TURN DEVICE CHAIN GUARD BRACE
34	400-00034	FLOOR AUGER HYD. MOTOR
35	700-80011	4- HOLE FLANGE BEARING
36	700-00218	MOTOR MOUNTING BRACKET
37	700-00070	FLOOR AUGER END PLATE
38	700-00072	SWIVEL RING
39	700-00271	REIN. CHANNEL FOR T-BAR
40	700-00076	BOLTING ANGLE RING
41	700-00004	STEP SPLINED BUSHING
42	700-00048	FLOOR AUGER FLIPPER GUSSET
43	700-00047	FLOOR AUGER FLIPPER
44	700-00009	HANGER BEARING SHAFT
45	700-00063	UHMW BEARING
46	200-00015	JAM NUT
47	700-00062	THREADED ROD
48	700-00098	1 X 3" DISCHARGE AUGER CYLINDER PIN
49	700-00273	VERTICAL & DISCHARGE IDLER BUSHING X 1 1/4"
50	700-00273	FLOOR AUGER IDLER BUSHING X 1 1/2"
51	700-00075	TRANSITION ASSEMBLY
52	700-00075	EXTRA LONG MOTOR MOUNTING BRACKET
53	700-80002	UNIVERSAL JOINT
54	700-80010	SINGLE #60 MASTER LINK
55	700-80008	DOUBLE #60 MASTER LINK
56	700-80024	SINGLE #80 MASTER LINK
57	700-80006	SINGLE #60 CHAIN
58	700-80012	DOUBLE #60 CHAIN
59	700-80023	SINGLE #80 CHAIN
60	700-80001	SINGLE #60 TURN DEVICE SPROCKET
61	700-80014	DOUBLE #60 TURN DEVICE SPROCKET
62	700-80025	SINGLE #80 TURN DEVICE SPROCKET
63	700-00104	TURN DEVICE GEAR BOX ASSEMBLY
64	700-00217	FRONT TURN DEVICE CHAIN GUARD BRACE
65	400-00030	TURN DEVICE HYD. MOTOR
66	700-00064	HANGER BEARING BRACKET
67	700-00088	VERTICAL AUGER FLIPPER GUSSET
68	700-00087	VERTICAL AUGER FLIPPER
69	700-00091	VERTICAL AUGER RAW MATERIAL
70	700-00099	1 X 5" VERTICAL AUGER CYLINDER PIN
71	700-80020	DOUBLE #50 MASTER LINK
72	700-80017	KEY-WAY SPROCKET
73	700-80018	SPLINED SPROCKET
74	700-00126	DOUBLE #50 CHAIN
75	700-00219	MOTOR MOUNT. BRKT. FOR CHAIN COUPLING DRIVE
76	700-00006	NITRATE STEP SPLINED BUSHING
77	700-00012	4-HOLE NITRATE BEARING SPACER ASSY.
78	700-00013	2-HOLE NITRATE BEARING SPACER ASSY.
79	700-00222	FLOOR AUGER END PLATE FOR FRONT MOUNT MOTOR
80	700-00271	DISCHARGE AUGER REINFORCEMENT CHANNEL
81	700-00289	RAW MAT. T-BAR SUPPORT FOR DISCHARGE
82	700-00289	TOP BEARING SUPPORT PLATE
83	700-00091	10" AUGER RAW MATERIAL
84	700-00091	NEW STYLE HANGER BEARING BUSHING